

PLASTIC ENCLOSURE

Plastic Enclosure - Stainless Steel Screws - TJ series - Grey Door & Clear Door

AIBOX non-metallic enclosures are corrosion proof and can use for many applications where non-metallic enclosures are required

Weight of non-metallic enclosures is 25% of the weight of steel enclosures and can use for similar applications where non-metallic enclosures are preferred. Non-metallic enclosures are having good insulation properties and light weight and give advantages over steel enclosures in some applications.

Plastic Enclosure - Stainless Steel Screws - TJ series - Grey Door & Clear Door comes with stainless steel screws and available in grey solid door or transparent door

Temperature range : -40°C to 120°C

ABS : Acrylonitrile Butadiene styrene

PC: Poly Carbonate

Screw Type		Dimension (mm)		Mounting Plate		Installation size (mm)	
Grey door	Clear door	W X H X XD	D1 + D2	Plastic	Metal	W3	H3
TJ-AG-0506	TJ-AT-0506	50 X 65 X 55	35 + 20	-	TJ-0506	37	52
TJ-AG-0507	TJ-AT-0507	55 X 70 X 43	35 + 8	-	TJ-0507	47	52
TJ-AG-0509	TJ-AT-0509	55 X 91 X 43	35 + 8	-	TJ-0509	47	78
TJ-AG-0709	TJ-AT-0709	75 X 91 X 43	35 + 8	-	-	67	78
TJ-AG-0712 - S	TJ-AT-0712 - S	75 X 125 X 48	40 + 8	-	TJ-0712	61	114
TJ-AG-0816 - S	TJ-AT-0816 - S	80 X 160 X 55	40 + 15	TJ-0816P	TJ-0816	68	148
TJ-AG-0816	TJ-AT-0816	80 X 160 X 90	75 + 15	TJ-0816P	TJ-0816	68	148
TJ-AG-0910	TJ-AT-0910	90 X 110 X 43	35 + 8	-	TJ-0910	78	102
TJ-AG-0912	TJ-AT-0912	90 X 125 X 48	40 + 8	-	TJ-0912	81	114

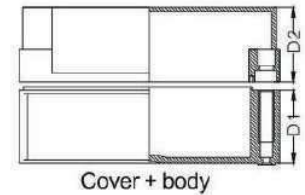
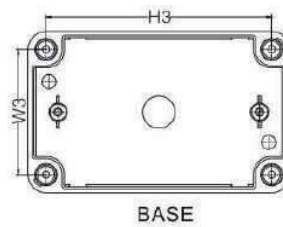

Steel mounting plate

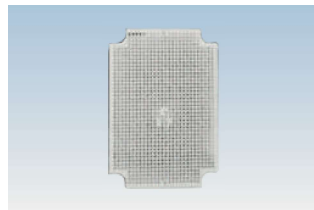

Plastic mounting plate



Wall brackets for Plastic Box
MODEL: WP - 01

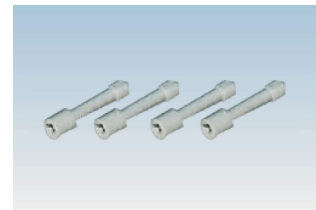

Plastic enclosure screw
MODEL: TJLT - 70



Plastic enclosure screw
MODEL: TJM - 60

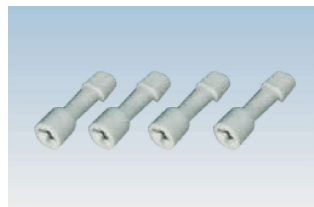

Plastic enclosure screw
MODEL: TJS - 50